

2 POS Circuit

3 POS

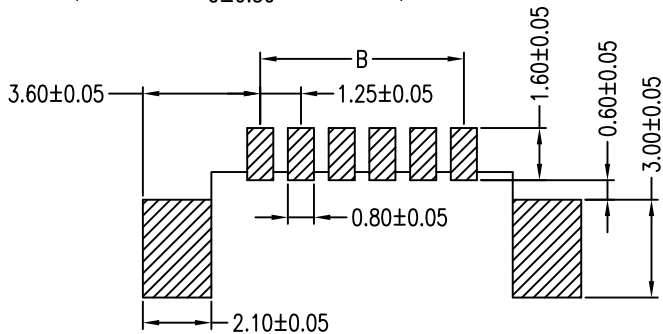
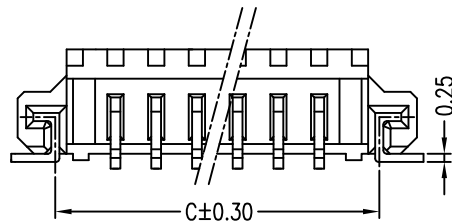
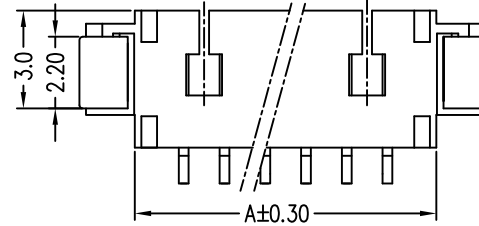
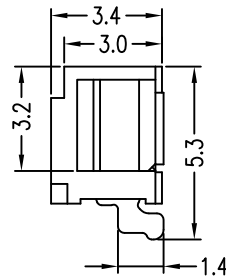
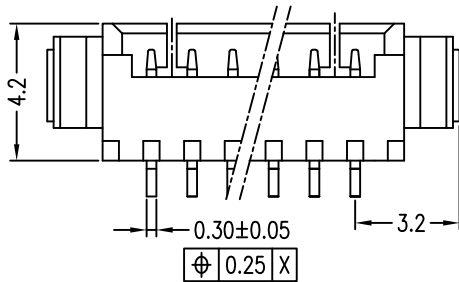

P.C. BOARD LAYOUT

NOTES:

1. SPECIFICATIONS

- Current Rating: 1A AC,DC
- Voltage Rating: 125V AC,DC
- Temperature Range: -40°C ~ +105°C
- Contact Resistance: 20mΩ Max.
- Insulation Resistance: 100MΩ Min.
- Withstanding Voltage: 500V AC/minute

2. Material & finish:

- Housing: Natural Thermoplastic, UL94V-0
- Contact and metal hold-down: Phosphor Bronze
- Plating of contact: Matte Tin or gold plating over Nickel
- Plating of metal hold-down: Matte Tin over Nickel

3. Ordering Information & Dimensions:

- 10114830- X X X XX LF
- Material: LCP
 - Plating: 0: Matte Tin, 1: Gold Flash
 - Packaging: 1: Tape & Reel
 - LF: See note A
 - pin counts from 02~15

PART NO.	Dimensions			
	A	B	C	D
10114830-xxx02LF	4.25	1.25±0.10	4.94	3.05
10114830-xxx03LF	5.50	2.50±0.10	6.19	4.30
10114830-xxx04LF	6.75	3.75±0.15	7.44	5.55
10114830-xxx05LF	8.00	5.00±0.10	8.69	6.80
10114830-xxx06LF	9.25	6.25±0.15	9.94	8.05
10114830-xxx07LF	10.50	7.50±0.15	11.19	9.30
10114830-xxx08LF	11.75	8.75±0.15	12.44	10.55
10114830-xxx09LF	13.00	10.00±0.15	13.69	11.80
10114830-xxx10LF	14.25	11.25±0.20	14.94	13.05
10114830-xxx11LF	15.50	12.50±0.20	16.19	14.30
10114830-xxx12LF	16.75	13.75±0.20	17.44	15.55
10114830-xxx13LF	18.00	15.00±0.20	18.69	16.80
10114830-xxx14LF	19.25	16.25±0.20	19.94	18.05
10114830-xxx15LF	20.50	17.50±0.20	21.19	19.30

Note A: The LF means RoHS compliance, the housing will withstand exposure to peak temperature 260 degree C for 5 sec in the IR re-flow process.

mat'l. code				tolerances unless otherwise specified				CUSTOMER COPY		 www.fciconnect.com	
ltr	ecn no	dr	date	linear	.X ± 0.25		projection		title		
A	T10-0145	J H	12/1/10		.XX ± 0.15				WTB 1.25MM WAFER 90° SMT		
					.XXX ±				product family WTB		
				angles	0° ±2°		MM		size: dwg no		code
				dr	JASON HSU	12/1/10			10114830		TWN
				enr	JASON HSU	12/1/10			sheet		1 of 1
				chr	GARY HSEH	12/1/10	scale	A4			
				appd	JOSEPH HSIA	12/1/10	1:1				
sheet index	revision sheet	A	1								